

BL SERIES

TWO WAY FULLRANGE LOUDSPEAKER

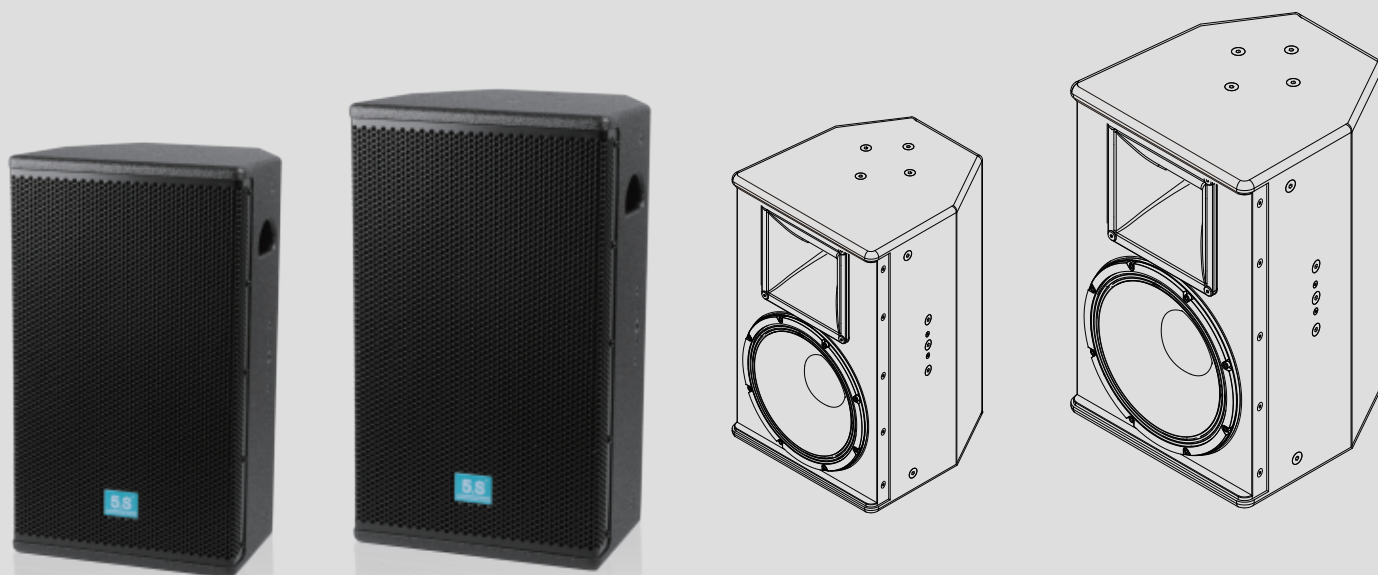

BL系列是运用欧洲先进的电声设计理念开发而成，其极致表现满足了高级别的扩声需求，同时BL系列的诞生也彰显了 **5.S** Audio 对极致好声音的追求。欧洲进口定制电感铜线、无感陶瓷电阻、阻燃玻璃纤维板+欧洲定制DIN (R-Cu57) 紫铜箔覆面的PCB板、定制独特聚丙烯电容——BL系列音箱的分频器均选用定制元器件，高效保证了分频点的无缝接合，使得整个声音密度高，平稳，优美，细腻。BL系列音箱重放出令人兴奋的动态，超精准的覆盖角度、极低的失真单元、超高声压级输出，一经推出便受到市场的广泛推崇。

BL series is developed based on European's concepts of advanced electronic sound design, which perfectly meets the needs of advanced sound amplification. The born of BL series indicate **5.S** Audio's commitment to the pursuit of the outstanding sound. Equipped with European customized inductors, non-inductive high-power aluminum resistance, anti-flaming glass fiber board plus PCB of surface by German DIN (R-Cu57) purple copper foil and customized capacitance. BL series speaker frequency divider are selected custom components, to ensure the seamless connection of frequency divider makes the whole sound density, smooth, beautiful and delicate. BL series can play superb dynamics, accurate dispersion HxV, and ultra-low distortion of bass unit and high SPL output, which has got highly appreciated.

- 2路高声压多用途全频扬声器系统 (High SPL output Multi-functional full-range loudspeaker system with 2-way design)
- 独特的1"喉口, 采用欧洲进口定制驱动单元 (1"horn unique design, customized driver originally imported from the European)
- 10"、12"、13"极低失真低音单元 (10" & 12" & 13" ultra-low distortion of bass unit)
- 箱体为平衡双向后导向精密设计 (Design of balance back oriented on the enclosure)
- 90° x 60° , 可旋转方形纤维塑钢号角 (90° x 60° rotating square plastic steel horn)
- 全频双通道功放驱动 (Full-frequency dual channel amplifier drive)
- 设计用于固定安装、KTV、夜总会、中/近场扩声或私人会所等 (Design for use in fixed setting, KTV, nightclub, near-field/midfield amplification and private club etc.)

BL-6010

FULLRANGE LOUDSPEAKER

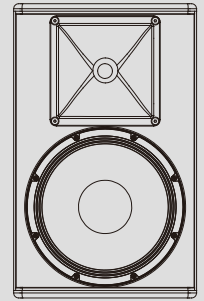

正面(Front)

技术参数(Technical Parameters)

| | |
|-----------------------------|---|
| 类型(Type): | 2路全频多用途扬声器系统(Two-way FullRange & multi-functional loudspeaker system) |
| 频率响应(Frequency Response): | 44Hz-20kHz |
| 功率(Rated Power): | 300W |
| 峰值功率(Peak Power): | 1200W |
| 阻抗(Impedance): | 8Ω |
| 覆盖角度(Dispersion HxV): | 90° *60° |
| 灵敏度(Sensitivity): | 94dB |
| 最大声压级(SPL): | 123dB |
| 分频点(Crossover Point): | 1.5kHz 内置分频 (Passive Crossover) |
| 输入连接器(Connectors): | 2*Neutrik™ 1+1- |
| 低频(LF): | 10"喇叭采用欧洲定制低音单元, 2.5"(63mm)音圈,额定功率为:300W(AES) 10" loudspeaker module, originally imported from European Voice coil: 2.5" (63mm). Rated power:300W (AES) |
| 高频(HF): | 1"喉口,采用欧洲定制高音压缩驱动单元, 1.75"(44mm)音圈, 额定功率为: 80W(AES) 1" horn, customized compression drivers originally imported from European Voice coil: 1.75"(44mm) Rated power: 80W (AES) |
| 箱体材料(Enclosure Materials): | 15mm+18mm航海级桦木夹板 (15mm& 18mm marine-grade Birch Plywood) |
| 箱体表面处理(Enclosure Paint): | 黑色聚脲油漆(Black Polyurea paint) |
| 尺寸(Dimensions): | 294mm*540mm*324mm(W*H*D) |
| 重量(Weight): | 17.3kg |

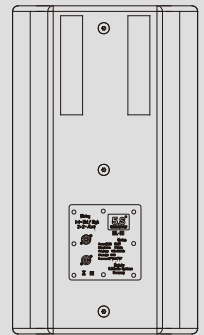

背面(Back)

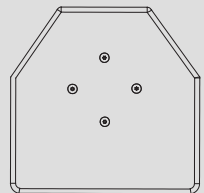

顶部(Top)

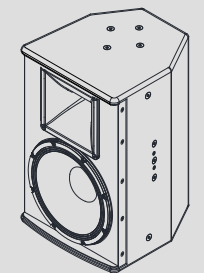

侧面(Side)

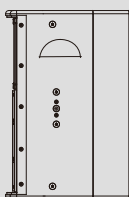

侧面(Side)

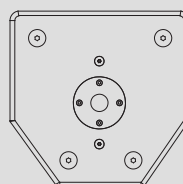

底部(Bottom)

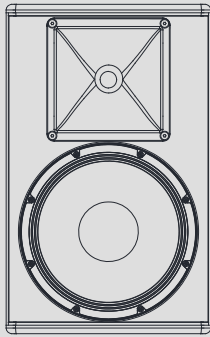

正面(Front)

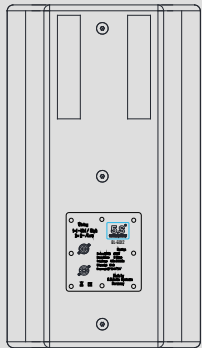

背面(Back)

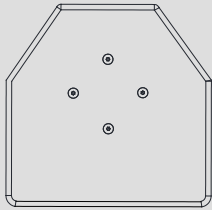

顶面(Top)

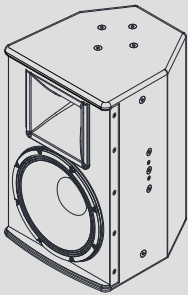

侧面(Side)

BL-6012

FULLRANGE LOUDSPEAKER



技术参数(Technical Parameters)

| | |
|---------------------------------|--|
| 型号: (Model) | BL-6012 |
| 类型: (Type) | 2路全频多用途扬声器系统(Two-way FullRange & multi-functional loudspeaker system) |
| 频率响应: (Frequency Response) | 42Hz-20kHz |
| 功率: (Rated Power) | 450W |
| 峰值功率: (Peak Power) | 1800W |
| 阻抗: (Impedance) | 8Ω |
| 覆盖角度: (Dispersion HxV) | 90° *60° |
| 灵敏度: (Sensitivity) | 95dB |
| 最大声压级: (SPL) | 126dB |
| 分频点: (Crossover Point) | 1.3kHz 内置分频 (Passive Crossover) |
| 输入连接器: (Connectors) | 2*Neutrik™ 1+1- |
| 定制 | |
| 低频: (LF) | 12"喇叭采用欧洲定制低音单元, 3"(75mm)音圈,额定功率为:450W(AES) 12" loudspeaker module,originally imported from European; Voice coil: 3" (75mm). Rated power:450W (AES) |
| 高频: (HF) | 1"喉口,采用欧洲定制高音压缩驱动单元, 1.75"(44mm)音圈, 额定功率为: 80W(AES) 1" horn, customized compression drivers originally imported from European ; Voice coil: 1.75"(44mm) Rated power: 80W (AES) |
| 箱体材料: (Enclosure Materials) | 15mm+18mm航海级桦木夹板 (15mm & 18mm marine-grade Birch Plywood) |
| 箱体表面处理: (Enclosure Paint) | 黑色聚脲油漆(Black Polyurea paint) |
| 尺寸: (Dimensions) | 360mm*605mm*360mm(W*H*D) |
| 重量: (Weight) | 21.6kg |

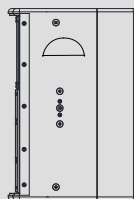

侧面(Side)

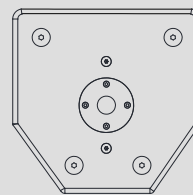

底部(Bottom)